

# DH-IPC-HDBW5541E-ZE

## 5MP IR Vari-focal Dome WizMind Network Camera



Launched by Dahua Technology, Dahua WizMind is a full portfolio of solutions composed of project-oriented products including IPC, NVR, PTZ, XVR, Thermal and software platform which adopts industry-leading deep learning algorithms. Focusing on customer's requirements, WizMind provides precise, reliable and comprehensive AI solutions for verticals.

### Series Overview

With starlight solution and deep learning algorithm, Dahua WizMind 5 Series network camera has various intelligent functions, including face capture, perimeter protection and people counting, which greatly improve the accuracy of video analysis.

### Functions

#### Face Detection

Dahua Face Detection technology can detect the face in the image. With deep learning algorithm, the technology supports detecting, tracking, capturing and selecting the best face image, and then outputs face snapshot.

#### Face Attributes

With deep learning algorithm, the network camera can recognize face attributes, such as gender, age, expression, glasses, mouth mask, and beard.

#### Perimeter Protection

With deep learning algorithm, Dahua Perimeter Protection technology can recognize human and vehicle accurately. In restricted area (such as pedestrian area and vehicle area), the false alarms of intelligent detection based on target type (such as tripwire, intrusion, fast moving, parking detection, loitering detection and gathering detection) are largely reduced.

#### People Counting

With deep learning algorithm, Dahua People Counting technology can track and process moving human body targets to realize the accurate statistics of enter No., leave No., and In Area No. Working with management platform, it outputs yearly/monthly/daily reports to meet your requirements.

- 5-MP 1/2.7" CMOS image sensor, low luminance, and high definition image.
- Outputs max. 5 MP (2592 × 1944)@20 fps.
- Built-in IR LED, and the max. illumination distance is 40 m.
- ROI, SVC, SMART H.264+/H.265+, AI H.264/H.265, encoding after filter, flexible coding, applicable to various bandwidth and storage environments.
- Rotation mode, WDR, 3D NR, HLC, BLC, digital watermarking, applicable to various monitoring scenes.
- Three switchable intelligent resources: IVS, face detection, and people counting.
- Alarm: 1 in, 1 out; audio: 1 in, 1 out; supports max. 256 G Micro SD card.
- 24 VAC/12 VDC/PoE power supply, easy for installation.
- ePoE; IP67 and IK10 protection.
- SMD 3.0.



#### ePoE

Dahua's innovative ePoE technology offers a new solution to transmit power and data over long distances between cameras and network switch, allowing more flexible design of surveillance system, improving reliability, reducing installation time and saving money. ePoE technology encompasses pure network systems where a single CAT6 cable can carry signals up to 300 m (984 ft) at 100 Mbps, 800 m (2625 ft) at 10 Mbps.

#### Cyber Security

Dahua network cameras employ a series of security technologies, including security authentication and authorization, access control protocols, trusted protection, encrypted transmission and encrypted storage. These technologies improve the camera's defense against external cyber threats and prevent malicious programs from compromising the device.

#### Protection (IP67, IK10, wide voltage)

**IP67:** The camera passes a series of strict test on dust and soak. It has dust-proof function, and the enclosure can work normal after soaking in 1 m deep water for 30 minutes.

**IK10:** The enclosure can stand the punch more than 5 times from a 5 kg hammer falling from a height of 40 cm (Impact energy is 20J).

**Wide voltage:** The camera allows  $\pm 30\%$  (for some power supplies) input voltage tolerance (wide voltage range), and it is widely applied to outdoor environment with instable voltage.

### Technical Specification

#### Camera

Image Sensor	1/2.7" CMOS
Max. Resolution	2592 (H) × 1944 (V)
ROM	128 MB
RAM	1 GB
Scanning System	Progressive
Electronic Shutter Speed	Auto/Manual 1/3 s–1/100,000 s
Min. Illumination	0.005 lux@F1.5 (Color, 30 IRE) 0.0005 lux@F1.5 (B/W, 30 IRE) 0 lux (Illuminator on)
S/N Ratio	>56 dB
Illumination Distance	40 m (131.23 ft) (IR)
Illuminator On/Off Control	Auto
Illuminator Number	4 (IR LED)
Pan/Tilt/Rotation Range	Pan: 0°–355° Tilt: 0°–65° Rotation: 0°–355°

#### Lens

Lens Type	Motorized vari-focal				
Lens Mount	φ14				
Focal Length	2.7 mm–13.5 mm				
Max. Aperture	F1.5				
Field of View	Horizontal: 100°–28° Vertical: 72°–21° Diagonal: 133°–35°				
Iris Control	Auto				
Close Focus Distance	0.8 m (2.62 ft)				
DORI Distance	Lens	Detect	Observe	Recognize	Identify
	W	64 m (209.97 ft)	25.6 m (83.99 ft)	12.8 m (41.99 ft)	6.4 m (21.00 ft)
	T	212 m (695.54 ft)	84.8 m (278.22 ft)	42.4 m (139.11 ft)	21.2 m (69.55 ft)

#### Smart Event

IVS	Abandoned object; missing object
Heat Map	Yes

#### Professional, intelligent

IVS (Perimeter Protection)	Intrusion, tripwire, fast moving (the three functions support the classification and accurate detection of vehicle and human); loitering detection, people gathering, and parking detection
SMD 3.0	Less false alarm, longer detection distance
Face Detection	Face detection; track; snapshot; snapshot optimization; optimal face snapshot upload; face enhancement; face exposure; face attributes extraction including 6 attributes (gender, age, glasses, expressions, mask, and beard) and 8 expressions (angry, sad, disgusted, scared, surprised, calm, happy, confused); face snapshot set as face or one-inch photo; snapshot strategies (real-time snapshot, quality priority and optimization snapshot); face angle filter; optimization time setting

#### People Counting

Tripwire people counting and people counting in area, generating and exporting report (day/month/year); queue management, generating and exporting report (day/month); 4 rules can be set for tripwire, people counting in area and queue management

#### Smart Search

Work together with Smart NVR to perform refine intelligent search, event extraction and merging to event videos

#### Video

##### Video Compression

H.265; H.264; H.264H; H.264B; MJPEG (Only supported by the sub stream)

##### Smart Codec

Smart H.265+; Smart H.264+

##### AI Coding

AI H.265; AI H.264

##### Video Frame Rate

Main stream: 2592 × 1944@(1 fps–20 fps); 2688 × 1520@(1 fps–25/30 fps)  
Sub stream: D1@(1 fps–50/60 fps)  
Third stream: 1080p@(1 fps–50/60 fps)  
\*The values above are the max. frame rates of each stream; for multiple streams, the values will be subjected to the total encoding capacity.

##### Stream Capability

3 streams

##### Resolution

2592 × 1944; 2688 × 1520; 2304 × 1296; 1080p (1920 × 1080); 1.3M (1280 × 960); 720p (1280 × 720); D1 (704 × 576/704 × 480); VGA (640 × 480); CIF (352 × 288/352 × 240)

##### Bit Rate Control

CBR/VBR

##### Video Bit Rate

H.264: 32 kbps–8192 kbps  
H.265: 32 kbps–8192 kbps

##### Day/Night

Auto(ICR)/Color/B/W

##### BLC

Yes

##### HLC

Yes

##### WDR

120 dB

##### Scene Self-adaptation (SSA)

Yes

##### White Balance

Auto; natural; street lamp; outdoor; manual; regional custom

##### Gain Control

Auto; manual

##### Noise Reduction

3D NR

##### Motion Detection

OFF/ON (4 areas, rectangular)

##### Region of Interest (RoI)

Yes (4 areas)

##### Image Stabilization

Electronic Image Stabilization (EIS)

##### Smart Illumination

Yes

##### Defog

Yes

##### Image Rotation

0°/90°/180°/270°

##### Mirror

Yes

##### Privacy Masking

8 areas

#### Audio

##### Audio Compression

PCM; G.711a; G.711Mu; G.726; G.723

**Alarm**

Alarm Event	No SD card; SD card full; SD card error; network disconnection; IP conflict; illegal access; motion detection; video tampering; defocus detection; scene changing; tripwire; intrusion; abandoned object; missing object; fast moving; parking detection; loitering detection; people gathering; input error; intensity change; people counting; face detection; voltage detection; people counting in area; stay detection; people number error detection; queue management
-------------	--

**Network**

Network Port	RJ-45 (10/100 Enhancement Base-T)
SDK and API	Yes
Cyber Security	Video encryption; firmware encryption; configuration encryption; Digest; WSSE; account lockout; security logs; IP/MAC filtering; generation and importing of X.509 certification; syslog; HTTPS; 802.1x; trusted boot; trusted execution; trusted upgrade
Network Protocol	IPv4; IPv6; HTTP; TCP; UDP; ARP; RTP; RTSP; RTCP; RTMP; SMTP; FTP; SFTP; DHCP; DNS; DDNS; QoS; UPnP; NTP; Multicast; ICMP; IGMP; NFS; SAMBA; PPPoE; SNMP; Bonjour
Interoperability	ONVIF (Profile S/Profile G/Profile T); CGI; P2P; Milestone
User/Host	20 (Total bandwidth: 88 M)
Storage	FTP; SFTP; Micro SD card (support max. 256 GB); NAS
Browser	IE: IE8 and later Chrome Firefox
Management Software	Smart PSS, DSS, DMSS
Mobile Client	iOS; Android

**Certification**

Certifications	CE-LVD: EN 62368-1 CE-EMC: Electromagnetic Compatibility Directive 2014/30/EU FCC: 47 CFR FCC Part 15, Subpart B UL/CUL: UL60950-1 CAN/CSA C22.2 No.60950-1-07
----------------	---

**Port**

Audio Input	1 channel (RCA port)
Audio Output	1 channel (RCA port)
Alarm Input	1 channels in: 5 mA 3 V–5V DC
Alarm Output	1 channel out: 300 mA 12V DC

**Power**

Power Supply	12 VDC (±30%)&24 VAC (±30%); PoE (802.3af); ePoE
Power Consumption	Basic: 4.9 W (12 VDC); 5.1 W (24 VAC); 5.2 W (PoE) Max. (max. stream + intelligence + IR on + focus): 12.4 W (12 VDC); 11.9 W (24 VAC); 11.6 W (PoE)

**Environment**

Operating Temperature	-30 °C to +60 °C (-22 °F to +140 °F)
Operating Humidity	≤ 95%
Storage Temperature	-40 °C to +60 °C (-40 °F to +140 °F)
Protection	IP67; IK10

**Structure**

Casing	Metal + plastic
--------	-----------------

Product Dimensions	Φ159 mm × 117.9 mm (6.26" × 4.64")
Net Weight	950 g (2.09 lb)
Gross Weight	1200 g (2.65 lb)

**Ordering Information**

Type	Model	Description
SMP Camera	DH-IPC-HDBW5541EP-ZE	5MP IR Vari-focal Dome WizMind Network Camera, PAL
	DH-IPC-HDBW5541EN-ZE	5MP IR Vari-focal Dome WizMind Network Camera, NTSC
Accessories (Optional)	PFA138	Junction Box Bracket
	PFB211W	Wall Mount Bracket
	PFB300C	Ceiling Mount Bracket
	PFA152-E	Pole Mount Bracket
	PFB201C	In-ceiling Mount Bracket
	PFA101	Mount Adapter
	PFM321D	12 VDC 1A Power Adapter
	LR1002-1ET/1EC	Single-port Long Reach Ethernet over Coax Extender
	PFM900-E	Integrated Mount Tester

**Accessories**

Optional:



PFA138 Junction Box Bracket



PFB211W Wall Mount Bracket



PFB300C Ceiling Mount Bracket



PFA152-E Pole Mount Bracket



PFB201C In-ceiling Mount Bracket



PFM321D 12 VDC 1A Power Adapter



LR1002-1ET/1EC Single-port Long Reach Ethernet Over Coax Extender



PFM900-E Integrated Mount Tester

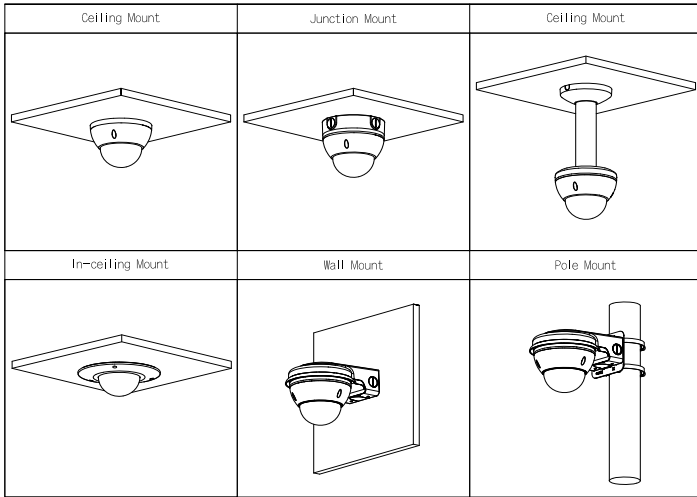

**Dimensions (mm[inch])**

